

Symposium Organizers

Shelley Adler, Ph.D.
Barbara Brenner
Floretta Chisom
Arlyne Draper
Robert Erwin
Bobbie Head, M.D., Ph.D.
Mary Ann Jordan, Ph.D.
Liana Lianov, M.D., M.P.H.
Susan Love, M.D., M.B.A.
Judith Luce, M.D.
Holly Mitchell
Maria Pellegrini, Ph.D.
Michele Rakoff
Kevin Scanlon, Ph.D.
Anne Wallace, M.D.

BCRP Staff

DIRECTOR

Marion Kavanaugh-Lynch, M.D., M.P.H.

RESEARCH ADMINISTRATORS

Laurence Fitzgerald, Ph.D.
Katherine McKenzie, Ph.D.
Walter Price, Dr. P.H.

ADMINISTRATIVE SUPPORT

DeShawn Boyd
Brenda Dixon-Coby
Garland Giles
Kim Landry
Ivy M. Savant

Table of Contents

5	Welcome from the Director
6	Floor Plan
7	Event Descriptions
8	Symposium at a Glance
11	Technical Session
14	Evening Events
16	General Program
19	Art Exhibitors
22	Exhibitors
23	Mistress of Ceremonies – Holly Mitchell
24	Keynote Speaker – Susan Love, M.D., M.B.A.
25	Guest of Honor - Cornelius L. Hopper, M.D.
26	Plenary Session Participants
30	Poster Sessions
36	Abstracts
79	Breast Cancer Research Council
81	Travel to the Symposium
83	Index

Welcome

On behalf of the Breast Cancer Research Program staff and Council, as well as the University of California, I am honored to welcome you to the 1999 California Breast Cancer Research Symposium.

The California Breast Cancer Research Program arose as a constructive expression of the anger and frustration of women with breast cancer. It was conceived of and developed through the energy, wisdom, and dreams of women that resulted from their experience with breast cancer. And their vision was that advocates' voices should be heard in all aspects of the Program.

I believe that health sciences research is moving towards a new paradigm – one in which partnerships between experts and lay people will become more commonplace and in which advocates, activists and community members will play a much more active role in decision-making and priority-setting. We have seen such a transformation in the practice of medicine – a previous paternalistic approach to medicine has been virtually replaced by a model in which the health care provider and the patient are seen as partners with equal roles in preserving and maintaining health. One of the goals of the California Breast Cancer Research Program is stimulate similar partnerships in breast cancer research. The Symposium is an opportunity to create these partnerships.

Our hope is that by creating this opportunity for activists, scientists, and all individuals concerned about breast cancer to hear the latest in progress from the innovative research funded by the Breast Cancer Research Program, you will interact with, and learn from, each other and expand your understanding of the breadth of breast cancer research.

The Plenary Panel arises from BCRP's commitment to ensure that the research funded by the Program not only increases knowledge, but is also translated into public health practice. In this panel presentation, the most current knowledge about avenues to breast cancer prevention will be discussed from the perspective of actions we all can take today.

While the losses to breast cancer that we all continue to witness can discourage and anger us, I believe that we will all leave this Symposium with an appreciation of the progress being made and with renewed vigor for the work we each do to end the tragedy of breast cancer.

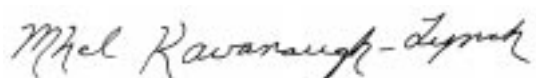

Marion Kavanaugh-Lynch, M.D., M.P.H.

Director

Floor Plan

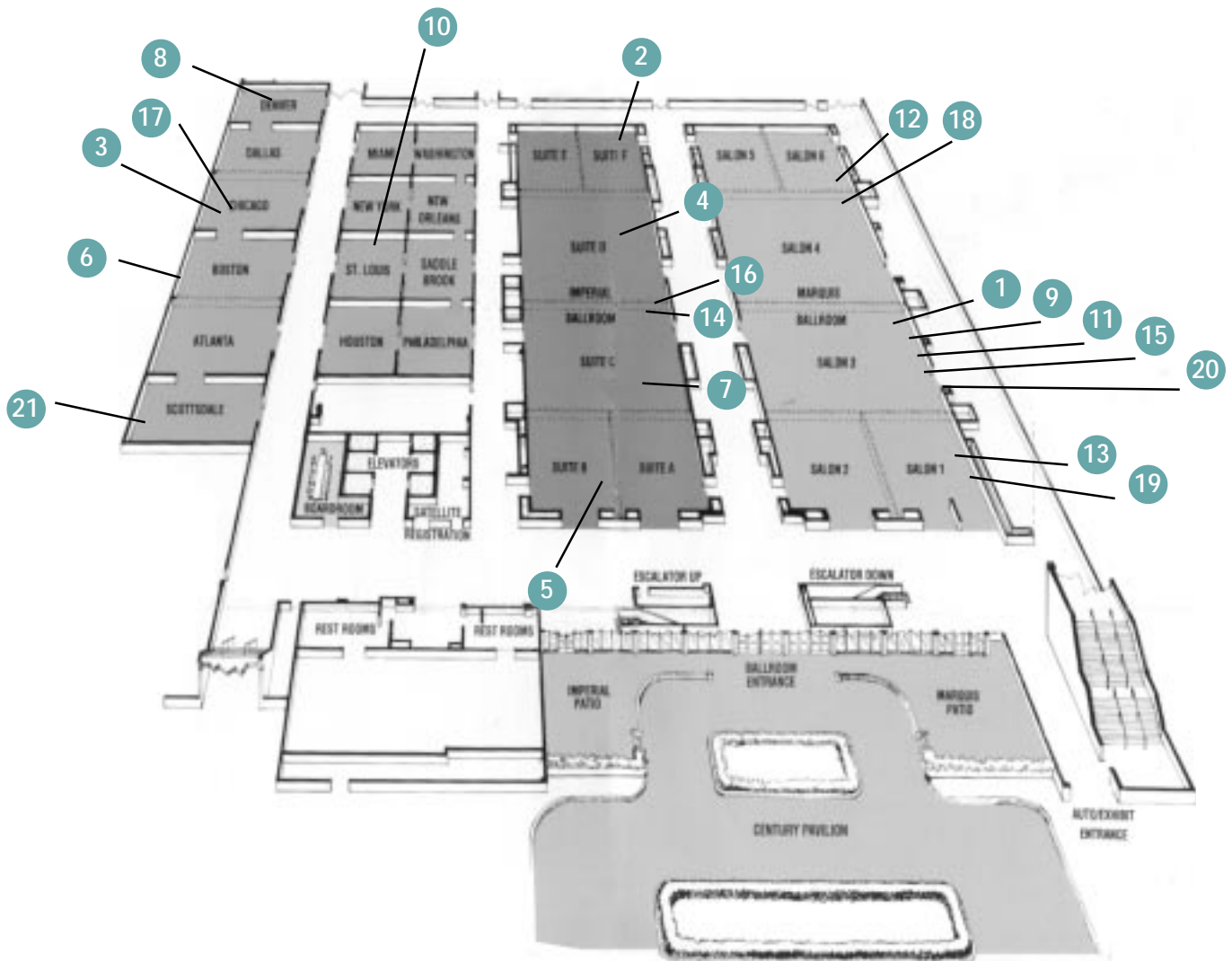

September 17, 1999

1 Welcome

Poster Discussion

- 2** Effect of Nutrition and Lifestyle
- 3** Detection and Treatment
- 4** Breast Cancer Susceptibility & Prevention
- 5** Biomarkers and Biology of Tumor Progression
- 6** Gene and Immunotherapy
- 7** Education and Support

8 Information for Cycle VI Applicants

9 Reception and Movie

September 18, 1999

10 Exhibitors

11 Welcome

12 Breakout Session: Gene Environment & Ethnicity

13 Breakout Session: Normal Breast Biology

14 Plenary Discussion

15 Lunch

16 Poster Viewing

17 Communities and Science

18 Breakout Session: Education and Support

19 Breakout Session: Emerging Breast Cancer Therapies

20 Closing Ceremonies

21 Slide Preparation Room

Event Descriptions

Breakout Sessions

Researchers will speak about topics that are pivotal to impacting breast cancer. Talks will be geared to a general audience and will be prefaced by a moderator who will give extensive background about the subject. There will be ample time for audience participation. (Saturday, September 18, 8:30 a.m. – 10:00 a.m. and 4:00 p.m. – 5:30 p.m.)

- *Gene, Environment, and Ethnicity*
- *Normal Breast and Biomarkers*
- *Education and Support*
- *Emerging Breast Cancer Treatments*

Closing Ceremonies

Breakout session moderators will summarize the highlights of their sessions. (Saturday, September 18, 5:30 p.m. – 6:00 p.m.)

Communities and Science

Symposium attendees can learn about ways to get involved in breast cancer research. (Saturday, September 18, 3:15 p.m. – 4:00 p.m.)

Exhibitor's Showcase

Non-profit organizations will present practical information about breast cancer (Saturday, September 18, 8:00 a.m. – 5:00 p.m.).

Information Meeting for Cycle VI Applicants

The BCRP staff will describe the grants available beginning July 1, 2000 and how to apply for them. (Friday, September 17, 5 p.m. – 6 p.m.)

Plenary Discussion: Avenues for Breast Cancer Prevention

Panelists will explore the possible strategies that we can start today to reduce the risk of developing breast cancer. (Saturday, September 18, 10:15 a.m. – 12:15 p.m.)

- *Environmental Influences on Breast Cancer - Suggestions for Environmental Policy*
- *Our Changing Lifestyle - Social Policy and Individual Choices*
- *Practicality of Chemoprevention - Promise and Pitfalls*
- *Approaches for Implementation: Communication, Education and Creating Change*

Poster Discussion Sessions

These sessions will feature in depth, moderated discussions of the most recent findings of BCRP-funded researchers. (Friday, September 17, 2 p.m. – 5 p.m.)

- *Effects of Nutrition & Lifestyle*
- *Detection & Treatment: Technologies & Access*
- *Breast Cancer Susceptibility & Prevention*
- *Biomarkers & Biology of Tumor Progression*
- *Gene & Immunotherapy: Targets & Application*
- *Education and Support*

Poster Viewing

BCRP investigators will display their research results in the form of posters. Posters will be available for viewing unattended (Friday, September 17, 1 p.m. – 2 p.m.) and attended by researchers (Saturday, September 18, 2 p.m. – 4 p.m.). Advocate guides will be available at the Saturday session to lead groups through the posters and to facilitate discussions between the scientists and audience.

Symposium

September 17



Technical Session

Time	Session	Location
12:50 p.m. - 1:00 p.m.	Welcome	Marquis Ballroom
2:00 p.m. – 3:00 p.m.	Effect of Nutrition & Lifestyle (Poster Discussion Session)	Suites E & F
2:00 p.m. – 3:00 p.m.	Detection & Treatment: Technologies & Access (Poster Discussion Session)	Chicago/ Dallas Room
3:00 p.m. – 4:00 p.m.	Breast Cancer Susceptibility & Prevention (Poster Discussion Session)	Suite D
3:00 p.m. – 4:00 p.m.	Biomarkers & Biology of Tumor Progression (Poster Discussion Session)	Suites A & B
4:00 p.m. – 5:00 p.m.	Gene & Immunotherapy: Targets & Application (Poster Discussion Session)	Atlanta/ Boston Room
4:00 p.m. – 5:00 p.m.	Education and Support (Poster Discussion Session)	Suite C
5:00 p.m. – 6:00 p.m.	Information for Cycle VI Applicants	Denver
6:00 p.m. – 7:00 p.m.	Reception	Marquis Ballroom
7 p.m.	Movie and Panel Discussion	Marquis Ballroom

September 18

at a Glance



General Program

Time	Session	Location
8:00 a.m. – 5:00 p.m.	Exhibitor's Showcase	St. Louis / Saddlebrook /NewYork/ New Orleans
8:00 a.m. – 8:20 a.m.	Welcome	Marquis Ballroom
8:30 a.m. – 10:00 a.m.	Gene, Environment, and Ethnicity (Breakout Sessions)	Salons 4, 5 & 6
8:30 a.m. – 10:00 a.m.	Normal Breast and Biomarkers (Breakout Sessions)	Salons 1, 2 & 3
10:15 a.m. – 12:15 p.m.	Avenues for Breast Cancer Prevention (Plenary Discussion Session)	Imperial Ballroom
12:30 p.m. –2:00 p.m.	Lunch	Marquis Ballroom
2:00 p.m. – 4:00 p.m.	Poster Viewing	Imperial Ballroom
3:15 p.m. – 4:00 p.m.	Communities and Science	Chicago/Dallas Room
4:00 p.m.– 5:30 p.m.	Education and Support (Breakout Session)	Salons 1, 2 & 3
4:00 p.m.– 5:30 p.m.	Emerging Breast Cancer Treatments (Breakout Session)	Salons 4, 5 & 6
5:30 p.m. – 6:00 p.m.	Closing Ceremonies	Marquis Ballroom
All Day	Slide Preparation Room	Scottsdale

Scientific Perspectives Research Collaboration Awards (SPRC)

Deadline:
Thursday,
Jan. 13, 2000

**Awards
Start**
July 1, 2000

Not a breast cancer researcher, but have an idea to move research forward?

The Scientific Perspectives Research Collaboration Award (SPRC) is BCRP's newest research award. It is designed to stimulate, facilitate and fund research that brings insights, tools and ideas from research disciplines not now integrated into breast cancer research to bear on the intractable problems of breast cancer.

What are the SPRC Awards?

There are two types of SPRC Awards:

SPRC Exploratory Award – an award for up to one year (\$100,000 maximum) to solidify organization structure and processes of the collaborative team; develop the project; and collect preliminary data

SPRC Full Research Award – an award for up to three years (no dollar cap, but \$2 million will be available) to execute the research plan developed during the exploratory phase.

Who are the Research Partners?

To be eligible for a SPRC, applicants must

1. Have collaborative partners from each of the following categories:
 - a. one (or more) independent investigator(s) experienced in breast cancer research
 - b. one (or more) investigator(s) experienced in another discipline outside breast cancer research
2. Be applying tools and ideas from this other discipline to a problem in breast cancer research

For more information, attend the "Information for Cycle VI Applicants" session (Friday, September 17, 5 p.m. – 6 p.m., Denver Room), see the BCRP Cycle VI Call for Applications or contact the BCRP Staff at (888) 313-BCRP (2277).

September 17



Technical Session

12:50 – 1:00 p.m.

Welcome

Marion H.E. Kavanaugh-Lynch, M.D.,
M.P.H.
Director, BCRP

Anne Wallace, M.D.
Breast Cancer Research Council Chair

1:00 – 2:00 p.m.

Poster Viewing

Poster Discussion Sessions:

2:00 – 3:00 p.m.

Effect of Nutrition & Lifestyle

Moderator:
Melissa Bondy, Ph.D.
M. D. Anderson Cancer Center
Suites E & F

Detection & Treatment: Technologies & Access

Moderator:
Laura Esserman, M.D.
University of California, San Francisco
Chicago/Dallas Room

3:00 – 4:00 p.m.

Breast Cancer Susceptibility & Prevention

Moderator:
Shiuan Chen, Ph.D.
Beckman Research Institute,
City of Hope
Suite D

Biomarkers & Biology of Tumor Progression

Moderator:
Carol MacLeod, Ph.D.
University of California, San Diego
Suites A & B

4:00 – 5:00 p.m.

Gene & Immunotherapy: Targets & Application

Moderator:
Jeffrey Smith, Ph.D.
The Burnham Institute
Atlanta/Boston Room

Education and Support

Moderator:
Patti Ganz, M.D.
University of California, Los Angeles
Suite C

5:00 – 6:00 p.m.

Information Meeting for Cycle VI Applicants

Cycle VI

Call for Applications

Attention Breast Cancer Researchers!!

The California Breast Cancer Research Program's Cycle VI Call for Applications will be released at the 1999 California Breast Cancer Research Symposium. Awards start July 1, 2000.

Learn about the awards at the "Information for Cycle VI Applicants" session (Friday, September 17, 5 p.m. – 6 p.m., Denver Room), See the BCRP Cycle VI Call for Applications or contact the BCRP Staff at (888) 313-BCRP (2277).

Research Priority Issues

Health Policy & Social Science

Health Care Delivery and Health Policy
Socio-cultural, Psychological and Behavioral Aspects of Breast Cancer

Public Health

Prevention of Breast Cancer
Etiology of Breast Cancer

Clinical Sciences

Earlier Detection of Breast Cancer
Innovative Treatment Modalities for Breast Cancer

Basic Sciences

Biology of the Normal Breast
Pathogenesis of Breast Cancer

Research Awards

◀ 1 Collaboration Awards

- Translational Research Collaboration Awards
- Community Research Collaboration Awards
- Scientific Perspectives Research Collaboration Awards
- Joining Forces Conference Awards



◀ 2 Investigator Initiated Awards

- IDEA I and II Awards
- Topic-Specific RFAs
 - Socio-cultural, Behavioral and Psychological Issues
 - Biology of the Normal Breast
 - Prevention, Risk Identification and Risk Reduction

◀ 3 Career Development Awards

- New Investigator Awards
- Postdoctoral Fellowships
- Training Program Awards

Application Deadlines

- ▶ CRC Concept Papers - Tuesday, October 19, 1999
- ▶ CRC Full Awards - Thursday, February 10, 2000
- ▶ Conference Awards - Before May 1, 2000
- ▶ All Other Awards - Thursday, January 13, 2000

1-800-313-BCRP

September
 17

Evening Events

6:00 p.m.

No Host Reception

7:00 p.m.

Screening of the movie
"Exposure: Environmental Links to
Breast Cancer"

8:00 p.m.

Panel Discussion

Joining Forces Conference Awards

- ▶ Is there a breast cancer research issue that needs to be **viewed** from a fresh perspective?
- ▶ Are you looking for opportunities to **brainstorm** with people outside your field?
- ▶ The "Joining Forces Conference Award" gives you \$25,000 to convene cross-disciplinary conferences on timely, **critical issues** to breast cancer research.

To Apply:

- ▶ Applications can be submitted at any time prior to **May 1, 2000**. They will be evaluated by the California Breast Cancer Research Council and funding decisions will be made within 90 days.

For more information,

- ▶ Attend the "Information for Cycle VI Applicants" session (Friday, September 17, 5 p.m. – 6 p.m., Denver Room), see the BCRP Cycle VI Call for Applications or contact the BCRP Staff at **1 - (888) 313-BCRP (2277)**.

Award Criteria:

- 1** **Relevance** of the conference to breast cancer research
- 2** **Strength** of outreach to ensure cross-disciplinary representation, especially from disciplines not now integrated in breast cancer research
- 3** **Potential** of the approach to generate new ideas and facilitate collaboration
- 4** **Qualifications** of applicants/ conference organizers
- 5** **Diversity** of scientific perspectives and activist/advocacy involvement
- 6** **Potential** to advance breast cancer research
- 7** **Appropriateness** of the budget for the scope of work
- 8** **Attentiveness** to the needs of California

September 18



7:00 a.m. – 1:00 p.m.

Registration

7:00 a.m. – 9:00 a.m.

Breakfast

8:00 a.m. – 5:00 p.m.

Exhibitor's Showcase

8:00 a.m. – 8:20 a.m.

Welcome

Marquis Ballroom

Holly Mitchell
Mistress of Ceremonies

Marion H. E. Kavanaugh-Lynch, M.D.,
M.P.H., Director of BCRP

Anne Wallace, M.D.
Breast Cancer Research Council Chair

8:30 – 10:00 a.m.

Gene, Environment, and Ethnicity

Salons 4, 5 & 6

Moderators:

Melissa Bondy, Ph.D.
M. D. Anderson Cancer Center

Vicki Boriack
Community Health Partnership
of Santa Clara County

8:30 – 10:00 a.m.

Normal Breast and Biomarkers

Salons 1, 2 & 3

Moderators:

Robert Cardiff, M.D., Ph.D.
University of California, Davis

Liz Lostumbo
National Breast Cancer
Coalition

Breakout Sessions:

A Case-control Study of Breast Cancer in Asian- Americans

Anna H. Wu, Ph.D.
University of Southern California

Vitamin D and Genetic Susceptibility

Sue Ingles, Dr. P.H.
University of Southern California

Metabolism of Environmental Chemicals as Breast Cancer Risk

Regine Goth-Goldstein, Ph.D.
Lawrence Berkeley National
Laboratory

BRCA1 Regulation in Breast Cancer: A Rat Mammary Model

Donna Williams-Hill, Ph.D.
University of Southern California

Role of Steroid Hormones in Normal Breast Development and Cancer

G. Shyamala, Ph.D.
Lawrence Berkeley National
Laboratory

Control of Growth and Invasion in Normal vs. Cancerous Breast Cells

Pierre Desprez, Ph.D.
California Pacific Medical Center

General Program

Plenary Discussion Session:

10:15 a.m. – 12:15 p.m.

Avenues for Breast Cancer Prevention

Imperial Ballroom

Moderator:

Barbara Brenner
Breast Cancer Action

Environmental Influences on Breast Cancer - Suggestions for Environmental Policy

Ana M. Soto, M.D.
Tufts University

Our Changing Lifestyle - Social Policy and Individual Choices

Graham Colditz, M.D., Dr. P.H.
Harvard University

Practicality of Chemoprevention - Promise and Pitfalls

Richard R. Love, M.D.
University of Wisconsin

Approaches for Implementation: Communication, Education and Creating Change

Cynthia Pearson
National Women's Health Network

12:30 – 2:00 p.m.

Marquis Ballroom

Lunch

Cornelius L. Hopper Award Presentations

Keynote Speaker Susan Love, M.D.

Breast Cancer -
A Work in Progress

2:00 – 4:00 p.m.

Imperial Ballroom

Poster Viewing

More than 80 BCRP researchers will present their most recent findings

3:15. – 4:00 p.m.

Chicago/Dallas Room

Communities and Science

Learn about ways community members and organizations can get involved in research.

September 18



General Program

Breakout Sessions:

4:00 – 5:30 p.m.

Education and Support

Salon 1, 2 & 3

Moderators:

Roshan Bastani, Ph.D.
University of California, Los Angeles

Terri O'Hara
Lesbian Cancer Support Services

Emotions and Cancer Progression

Janine Giese-Davis, Ph.D.
Stanford University

Promoting Breast Cancer Education in Vietnamese Americans

Stephen McPhee, M.D.
University of California, San Francisco

Screening Mammography Prevalence in an Urban Underserved Area

Bruce Allen, Dr. P.H.
Charles R. Drew U. of Medicine & Science

5:30 – 6:00 p.m.

Closing Ceremonies

Marquis Ballroom

Holly Mitchell

Breakout Session Moderators

4:00 – 5:30 p.m.

Emerging Breast Cancer Treatments

Salon 4, 5 & 6

Moderators:

Gail Eckhardt, M.D.
University of Colorado, Health Sciences Center

Karen Lewkowitz
Y-ME Breast Cancer Network of Arizona

Pre-Clinical Cryosurgery Testing for Breast Cancer Treatment

Boris Rubinsky, Ph.D.
University of California, Berkeley

Leukocyte Recruitment, Angiogenesis and Breast Cancer

P. Sriramarao, Ph.D.
La Jolla Institute for Experimental Medicine

HER-2 Receptor-Directed Therapy for Breast Cancer

Richard Pietras, M.D., Ph.D.
University of California, Los Angeles

Art Exhibitors

Marilyn Gayler Axelrod

Wall of Hope Breast Cancer Survivors' Project

The Wall of Hope is a collection of more than 1,200 color portraits of breast cancer survivors from all over California depicting the depth and breadth of the disease by age, gender, race, and years surviving breast cancer.

Eileen Brabender

"Parallel Lives" 1999: Within 5 months of each other, a mother and daughter each receive a breast cancer diagnosis.

"Undivided Heart" Cancer stripped away some outer leaves (symbolized by an artichoke heart), it did not divide my heart.

"Saving Time in a Bottle" **Time is not endless – all of my someday are today.**

Breast cancer has asked me to look into my own heart as well as into the hearts and faces of others who have also been impacted by this disease. Much of my photography interprets the ways life takes on a new shape with different priorities after the struggle and the healing. (Eileen Brabender is the Chair of the Los Angeles Breast Cancer Alliance).

Vernal Branch

California Breast Cancer Organizations (CABCO)

"Forget Me Not: A Breast Cancer Photo Essay"

Memorial photos of women who have been taken from us by breast cancer are displayed to ensure we do not forget those we have lost as we work to prevent further losses.

Betsy Bryant

"Chemo", **"Supporting Hands"**, and **"No Less Than"**

I was diagnosed with breast cancer in the Spring of 1996. I had a lumpectomy, intensive chemotherapy and six months of radiation. During this time I wrote almost every day and I painted when I could. I created a series of paintings and sculptures about my journey with breast cancer. My work is still about processing this experience.

Denise Dalton

Director and Curator

Breast Art and Education Project

Twenty unique pieces of wearable "Breast Art" will either be on display or worn by Breast Cancer survivors. This art worn upon places of trauma reaches out, not as a reproduction of loss, but as a symbol of courage and life and the wonder of our temporal selves. Thus, we open new doors of expression and affirmation for women with breast cancer.

Michele Rakoff

"Creative Expressions"

You are never the same after cancer. My life is not worse, it is just different. I feel every day, and every day I feel more of life. My art has become a major source for my healing. Sometimes it is difficult for me to put into words my deepest feelings and emotions. But through sculpturing and painting, these emotions just flow. I paint and sculpt for me.

Antonia Richard

"My Support Group"

The portraits in this exhibit represent the overwhelming professional support as well as the interaction of survivors and friends during treatment.

Gwen Rodgers

"Inspirations, Women Facing Breast Cancer"

This exhibit is a collection of black and white photographs and quotations of women with breast cancer. It has been featured in the Los Angeles Times and is currently being printed as a 15 month calendar.

Ana Smulian

"Seven Out Of Eight Don't"

I read in the newspaper that a local doctor/researcher had stated that since seven out of eight women don't get breast cancer it's a **rare disease!** Creating this piece helped me deal with the rage I felt about this man's words. The figures, though similar, are different – as each of us is different. The eighth piece is torn apart, signifying what happens when you find out that **you** have breast cancer. The tearing apart of one's self, along with your loved ones, is visiting hell and coming back alive – at least for now. On the eighth figure, an "X" marks the spot where cancer was detected; the inside is painted red, signifying the blood and pain following diagnosis. A fragmented mirror reflects that this one woman out of eight can be any one of us.

Does your community have concerns about breast cancer?

- Do you want to find answers to research questions that address the concerns of a Community?
- BCRP encourages research and/or health professionals to partner with community groups to investigate issues that are important to both.
- Learn about the CRC Awards and how to apply for them at the “Communities and Science” Session (Saturday, September 18, 3:15 p.m. – 4 p.m., Chicago/Dallas Room) or contact the BCRP Staff at **(888) 313-BCRP (2277)**.

Application Deadlines:

Concept Papers (required):
Tuesday, October 19, 1999

Applications:
Thursday, February 10, 2000

Apply for the Community Research Collaboration Awards (CRC)!

What are the CRC Awards?

There are two types of CRC Awards:

- **CRC Pilot Award** – an award for up to one year (**\$100,000 maximum**) to develop the project and collect preliminary data
- **CRC Full Research Award** – an award for up to three years (**\$500,000 maximum**) to execute the research plan developed during the pilot phase

Areas of particular interest to BCRP are

- New methods of **dissemination of information** about breast cancer
- New methods to **increase patient access** and accrual to breast cancer clinical trials
- New methods to **improve patient support** at diagnosis, treatment and recurrence
- Identifying new or not yet established **risks for breast cancer**
- Ethical use, implications, public policy, and support for genetic testing for **breast cancer susceptibility**
- Methods to **facilitate diffusion of new practices** into widespread clinical use

1-888-313-BCRP

Exhibitors

American Cancer Society California Division

Cecilia Olkowski, MBA
1710 Webster Street
Oakland, CA 94612

Breast Cancer Action

Barbara Brenner
55 New Montgomery, Ste 323
San Francisco, CA 94105

Breast Cancer Alliance of California

Caroline Bliss-Isberg
15210 Upper Ellen Road
Los Gatos, CA 95033

California Department of Health Services

Cancer Detection Section
Michelle Mussuto
601 N. 7th Street MS 294
PO Box 942932
Sacramento, CA 94234-7320

Cancer Detection Center

Marvin Feldman, J.D.
1136 West Sixth Street, Ste 110
Los Angeles, CA 90017

Healing Journeys

Jan Adrian
PO Box 250
Aptos, CA 95001

Inflammatory Breast Cancer Research Foundation

c/o BioEnergy Fields Foundation –
Marina Del Rey, CA
G. Owen Johnson – Karen Blaze,
Ph.D.
3960 Coventry Drive
Anchorage, AK 99507

Los Angeles County Affiliate Susan G. Komen Breast Cancer Foundation

Linda S. Pura, R.N., MPA
33 South Catalina Avenue
Pasadena, CA 91106

Memorial Health Services Memorial Care Breast Centers

Lauren Spilsbury
9900 Talbert Avenue
Fountain Valley, CA 92708

NCI's Cancer Information Service

**UCLA Jonsson Comprehensive
Cancer Center**
Marie-Paula Van Herle
10940 Wilshire Blvd. Ste 1710
Los Angeles, CA 90024

Orange County Breast Cancer Partnership

Raul Sobero
12 Civic Center Plaza, Ste 127
Santa Ana, CA 92701

Planned Parenthood Los Angeles

Patricia Osozio
1920 Marengo Street
Los Angeles, CA 90033

Save Ourselves Y-Me of Sacramento

Sandy Walsh
900 Kent Drive
Davis, CA 95616

Sister in Survival – Education Advocacy Project

Rebecca Charles, R.N.
2100 C Northshore Drive
Eastlake, CA 91921

The Wellness Community – South Bay Cities

Marya Foley
109 W. Torrance Blvd.
Redondo Beach, CA 90277

Wall of Hope Breast Cancer Survivors' Project

Marilyn Gaylor Axelrod
PO Box 2393
Davis, CA 95617-2393

WIN Against Breast Cancer

Shelly Blechman
19325 E. Navilla Pl.
Covina, CA 91723-3244

California Breast Cancer Organizations (CABCO)

Vernal Branch
8775 Aero Drive, #302
San Diego, CA 92123-1756

Women of Color Breast Cancer Survivors Support Project

Carolyn Tapp – Nanette White
8610 S. Sepulveda Blvd. #200
Los Angeles, CA 90045

Mistress of Ceremonies

Holly Mitchell

Holly Mitchell is the past Executive Director of the California Black Women's Health Project (CBWHP), a women's health advocacy organization that is committed to improving the health of Black women in California. She has recently taken a new position as Legislative Advocate at the Western Center of Law and Poverty. She has been actively involved in public policy and service through her former positions as a graduate fellow in the Coro Foundation; a senior consultant to the Senate Committee on Health and Human Services for State Senator Diane Watson; and as a project director for the California Women's Health Project, a program of the California Elected Women's Association (CEWAER). A local activist and staunch supporter of women's rights, Ms. Mitchell volunteers with numerous community-based organizations and serves on several boards of directors including: The Center for Community Health and Well Being (home of the nationally recognized Birthing Project); Save Ourselves, a breast cancer advocacy and peer support organization; the Dangerfield Institute, a foster care organization; the Office of Women's Health Advisory Council; and the Sacramento County Public Health Advisory Board.. She formerly served on the board of Planned Parenthood of Sacramento Valley; co-chaired the Gold Country BCEDP Regional Partnership; and was a member of the California Breast Cancer Research Council from 1998-99.

Keynote Speaker

Susan Love, M.D., M.B.A.

Susan M. Love, M.D., M.B.A. is an author, teacher, surgeon, researcher and activist. She is an Adjunct Professor of Surgery at UCLA and the Medical Director of the Santa Barbara Breast Cancer Institute, a nonprofit organization dedicated to the eradication of breast cancer. She is a retiring member of the California Breast Cancer Research Council; one of the founders and a board member of the National Breast Cancer Coalition; and was appointed by President Clinton to the National Cancer Advisory Board. She is engaged in research to develop an intraductal approach to breast cancer.

She is the author of *Dr. Susan Love's Breast Book* and *Dr. Susan Love's Hormone Book*. Beginning October 1999, SusanLoveMD.com will provide an in-depth internet site for women with breast cancer, those who are at risk, and those who care about them.

Guest of Honor

Cornelius L. Hopper, M.D.

Vice President for Health Affairs, University of California, Office of the President

The Cornelius L. Hopper Scientific Achievement awards are named in honor of Dr. Cornelius Hopper. Dr. Hopper is retiring as the Vice President for Health Affairs at the University of California, Office of the President after almost 20 years. Dr. Hopper has been instrumental in providing guidance and support to the California Breast Cancer Research Program since its inception.

Cornelius L. Hopper, a neurologist and vice president for health affairs at the University of California, earned his M.D. degree from the University of Cincinnati College of Medicine and served residencies in internal medicine and neurology at Marquette University and University of Wisconsin, Madison. During the 1970's, as Vice President for Health Affairs at Tuskegee Institute, he created and developed the first National Health Service Corps. field station in the Southeastern U.S., as well as the nation's first rural, community-based Area Health Education Center.

As head of the University of California Office of Health Affairs, Dr. Hopper oversees long-range planning and policy development for a statewide health sciences academic establishment that is the nation's largest, encompassing 14 health professions schools that enroll 13,000 students and provide clinical training in UC's major medical centers and affiliated hospitals throughout the state. He has organized statewide research programs in AIDS, tobacco-related diseases and breast cancer that have awarded more than \$300 million in grants to California scientists. He is the principal presidential representative to the state legislature and state agencies in health sciences matters. He is a California Health Manpower Policy Commissioner and represents UC on the national Association of Academic Health Centers. Dr. Hopper established and served as chair of the UC committee that produced *Changing Directions in Medical Education*, a plan that shifts the mission and criteria of the university's schools of medicine to accommodate expanded primary care training.

Plenary Participants

Barbara Brenner

Ms. Brenner was 41 years old when she was diagnosed with breast cancer. She quickly learned how little was known about breast cancer, and how much misinformation was being given to the public about the disease. She joined the board of Breast Cancer Action in September 1994 and became the organization's Executive Director a year later. Breast Cancer Action is a San Francisco-based national grassroots organization that carries the voices of people affected by breast cancer to compel and inspire the changes necessary to end the breast cancer epidemic. As Executive Director, Ms. Brenner is responsible for implementation of the organization's programs designed to dispel the myths about breast cancer, to inform the public about the realities of the disease, and to encourage more people to do something — besides worry — about the breast cancer epidemic. She represents Breast Cancer Action on committees addressing a wide-range of breast cancer issues, writes for Breast Cancer Action's widely-acclaimed bi-monthly newsletter, and is a frequent public spokesperson on issues ranging from detection to treatment to prevention.

Graham A. Colditz, M.D., Dr.P.H.

Graham A. Colditz, M.D., Dr.P.H. is a Professor of Medicine at Harvard Medical School and Professor of Epidemiology at the Harvard School of Public Health and a Senior Epidemiologist in the Department of Medicine, Channing Laboratory, Brigham and Women's Hospital and Head of the Chronic Disease Epidemiology Group at Channing Laboratory. He received his B.Sc. and M.B., B.S. from the University of Queensland and his Doctorate in Public Health from Harvard University, School of Public Health. Dr. Colditz's research interests include the epidemiology of chronic diseases, the burden of smoking and obesity on health, the prevention of colon and colorectal cancer, breast cancer, applications of meta-analysis in medical sciences and prevention policy.

Plenary Participants

Richard R. Love, M.D.

Richard R. Love, M.D. is a professor in the departments of Medicine and Family Medicine, at the University of Wisconsin-Madison. His expertise is in research in prevention and treatment of breast cancer, particularly with interventions of limited toxicity; and delivery of cancer prevention and screening services in primary care medical practice. Dr. Love is particularly interested in clinical breast cancer research in other countries, which can be of major benefit to all women in the U.S. and worldwide; and the challenges of technology transfer of scientific findings of all kinds to populations.

Cynthia A. Pearson

Cynthia A. Pearson is Executive Director of the National Women's Health Network. She is responsible for representing the Network's position to Congress and Federal agencies such as the Food and Drug Administration and the National Institutes of Health. In addition, Ms. Pearson represents the Network on the Board of Directors of the National Breast Cancer Coalition, and the Steering Committee of the National Action Plan on Breast Cancer where she is co-chair for the Etiology Working Group. In the past, Ms. Pearson served as Executive Director at Womancare, a community-based clinic in San Diego, California. In the past 12 years she has presented addresses on women's health care at many symposia, conferences, and annual meetings throughout the United States.

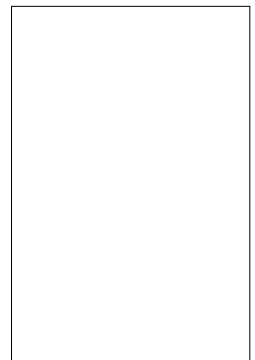

Ana Soto, M.D.

Dr. Soto has been researching the mechanism of action of estrogens on cell proliferation for more than twenty years. Her research on environmental estrogens stems from the accidental finding that plasticware in which human serum was stored shed an estrogen-mimicking chemical. Recently, she has developed a bioassay (the E-SCREEN test) that detects estrogenicity in chemical compounds. Using this assay, she found that toiletries, plastics, and spermicides may release estrogenic compounds. She has also uncovered the estrogen-like activity of certain pesticides. She hypothesizes that these estrogens may act cumulatively as reproductive disruptors and may increase the incidence of breast cancer. Applications of the E-SCREEN assay might include its adoption as an estrogen screening tool by governmental regulatory agencies and chemical manufacturers. The E-SCREEN is also used to test environmental samples such as water for the presence of estrogenic contamination. It is being used to measure the xenoestrogen burden of human serum and fat. The E-SCREEN test provides information necessary to regulate the release of environmental substances that may have deleterious estrogenic properties on wildlife and humans.

Donations

**Send to:
California Breast Cancer Research Program
University of California
Office of the President
300 Lakeside Drive 6th Floor
Oakland, CA 94612**

The California Breast Cancer Research Program (BCRP) receives its funding through state appropriations from two sources:

- Revenue from a 2-cent-per-pack tax on cigarettes
- Revenue from the state income tax return Line 52 check-off, Line 52

BCRP also accepts donations to support breast cancer research. Donation checks should be made payable to The Regents of the University of California and should be accompanied by a letter stating that the funds are designated for the Breast Cancer Research Program.

Donations are deposited in BCRP's gift account and are used to advance the Program's objectives. You will receive confirmation of receipt of the gift.

If the donation is made in the memory or honor of another person and the friend's or family's address is provided, BCRP will acknowledge receipt of the gift. Dollar amounts are not included in the letter of acknowledgement.

Donations have been made in memory or in honor of:

**Karen Warmdahl
Julie Babel Inarchy
Rachel Brick
Karen Horsely Murphy**

Donations

Thank you for making donations to the California Breast Cancer Research Program through LINE 52 (step 10) on your California Income Tax form

California Resident Income Tax Return 1998		540
Step 10	47 Contribution to California Seniors' Special Fund. See instructions ● 47	
	You may make a contribution of \$1 or more to:	
Contributions	48 Alzheimer's Disease/Related Disorders Fund ● 48	00
	49 California Fund for Senior Citizens ● 49	00
	50 Rare and Endangered Species Preservation Program ● 50	00
	51 State Children's Trust Fund for the Prevention of Child Abuse ● 51	00
	52 California Breast Cancer Research Fund ● 52	100
	54 California Public School Library Protection Fund ● 54	00
	55 D.A.R.E. California (Drug Abuse Resistance Education) Fund ● 55	00
	56 California Military Museum Fund ● 56	00
	57 California Mexican American Veterans' Memorial ● 57	00
	58 Emergency Food Assistance Program Fund ● 58	00
	59 Add line 47 through line 58. These are your total contributions ● 59	100

Your dollars supported the following research projects in 1999.

- ▶ Breast Cancer Survivorship: Partner's Role in Recovery
Beth E. Meyerowitz, Ph.D.
University of Southern California – Department of Psychology
- ▶ Breast Cancer Prevention by a Dominant Negative ER Variant
Vicki Davis, Ph.D.
Cedars-Sinai Medical Center
- ▶ Do Community Cancer Groups Enhance Well-Being?
Matthew J. Cordova, Ph.D.
Stanford University – School of Medicine

Your continued support will help us to fund more deserving projects in 2000.

Don't forget to contribute to the California Breast Cancer Research Program on line 52 (step 10).